

Archaeological Investigation and Assessment of Land at 148 Mitcham Road and Land adjoining 1 Hatton Road, Croydon CRO 3JE

Site Code HATT/SMS/14



Date of Report: 12/08/14

Applications 12/02548/F and 13/01099/P
Report for Skillcrown Homes Ltd

SWAT ARCHAEOLOGY

Swale and Thames Archaeological Survey Company
The Office, School Farm Oast, Graveney Road
Faversham, Kent ME13 8UP

Tel; 01795 532548 or 07885 700 112

info@swatarchaeology.co.uk www.swatarchaeology.co.uk

Contents

| | |
|---|---|
| 1.0 SUMMARY..... | 4 |
| 2.0 INTRODUCTION..... | 4 |
| 2.1 PLANNING BACKGROUND..... | 4 |
| 3.0 SCHEDULE OF VISITS..... | 4 |
| 4.0 AIMS AND OBJECTIVES..... | 5 |
| 4.1 PROPOSED GROUNDWORKS..... | 5 |
| 4.2 CONFIDENCE RATING..... | 5 |
| 5.0 ARCHAEOLOGICAL & GEOLOGICAL BACKGROUND..... | 5 |
| 6.0 METHODOLOGY..... | 5 |
| 7.0 RESULTS..... | 6 |
| 7.1 GENERAL..... | 6 |
| 8.0 FINDS..... | 6 |
| 9.0 DISCUSSION..... | 6 |
| 10.0 CONCLUSION..... | 6 |
| 11.0 ACKNOWLEDGMENTS..... | 6 |
| REFERENCES..... | 7 |
| APPENDIX 1 - HER Summary Form..... | 7 |

Plate 1. Aerial Photograph of site (Google 2013)

Plate 2. General view of site

Plate 3. View of the site showing foundation trenches

Plate 4. View of cut foundation trenches

List of Figures

Figure 1. Site plan

Figure 2. Proposed development

Archaeological Investigation and Assessment of Land at 148 Mitcham Road and Land adjoining 1 Hatton Road, Croydon CRO 3JE

Site Code HATT/SMS/14

Date of report: 12/08/14



Plate 1. Aerial view of site (red circle) showing the site prior to development.

(GoogleEarth 7/9/2013 eye alt 215m).

1.0 Summary

1.1. From June 23rd to 25th June 2014 Swale and Thames Archaeological Survey Company (SWAT Archaeology) carried out an Archaeological Investigation and Assessment on ground works involved in the build of a new housing development at land at 148 Mitcham Road and adjoining land at 1 Hatton Road, Croydon (Fig. 1 & Plate 1).

1.2. The works were carried out on behalf of the owners and instructions received from Skillcrown Homes Ltd.

1.3. The area for the building footprint and car parking plus access road was reduced with a machine using a bladed bucket under close archaeological supervision (Plates 2-4).

The archaeological work was undertaken in two phases.

Phase 1: Topsoil strip and reduction of Site (Site B)

Phase 2: Foundation and services excavated –Site B (Figs. 2, 3, 4).

1.4. The Archaeological Watching Brief was to watch for any signs of Prehistoric activity, and any other archaeological remains.

1.5. The Planning Application Numbers for the development are: 12/02548/F and 13/01099/P.

1.6. Although the archaeological potential was low to medium the Archaeological Investigation revealed no buried archaeological features and no archaeological finds were retrieved.

2.0 Introduction

2.1 Planning Background

Planning applications 12/02548 and 13/01099/P was submitted to the Local Planning Authority. Mark Stevenson (EH GLASS), on behalf of the Local Planning Authority (LPA) requested that an Archaeological Investigation and Assessment be undertaken in order to record any archaeological remains uncovered during the development work. The following condition (8) was attached to the planning consent:

No development shall take place until the applicant has secured the implementation of archaeological work in accordance with a written specification and timetable which has been submitted to and approved by the Local Planning Authority. The development shall only take place in accordance with the detailed scheme pursuant to this condition. The archaeological works shall be carried out by a suitably qualified investigating body acceptable to the Local Planning Authority.

Informative The development of this site is likely to damage archaeological remains. The applicant should therefore submit detailed proposals in the form of an archaeological project design. The design should be in accordance with appropriate English Heritage guidelines.

3.0 Schedule of Visits

An archaeologist from SWAT Archaeology (Dr Paul Wilkinson MifA) attended the site and controlled and supervised the excavation works from 23rd to 25th June 2014.

4.0 Aims and Objectives

4.1. The reason for the Archaeological Strip, Map and Sample, were to:

“establish the presence or absence of any elements of the archaeological resource across the area of the proposed development site “.

4.2. The ground works were to strip the topsoil/subsoil and excavate foundation trenches on Plot B. Plot A construction was for piling with no ground reduction (Plates 2-4).

4.3. A full programme of proposed works by the contractor were made available to SWAT Archaeology before the on-site monitoring took place.

4.4. Confidence Rating

No factors hindered the recognition of archaeological and deposits during the monitoring and recording exercise.

5.0 Archaeological and Geological Background

5.1. The underlying geology at the site according to the British Geological Survey map consists of London Clay Deposits forming the London Basin. The British Geological Survey Sheet 270 (South London 1998) shows the proposed development area (PDA) to lie within a small area of Hackney Gravels defined as ‘Post-diversionary Thames River Terrace Deposits: gravel, sandy and clayey in part (BSG website 1: 50,000). The geology revealed on site was sandy clayey gravel under made ground of about 1m-1.25m thick (Fig. 3).

5.2. The application site consisted of one parcel of land (Plot B), formally a derelict pub and car scrapyard fronting Mitcham Road, Hatton Road and Sumner Road totalling 0.10 hectare in extent. The site is centred at TQ 314 667 within the London Borough of Croydon.

5.3. The proposed development area (PDA) lies within an area of known archaeological potential associated with past discoveries at recent archaeological investigations around the PDA. These include finds from the Mesolithic found within a 750m radius of the PDA, and Neolithic flintwork found at Canterbury Road to the north-west of the PDA (MLO 19621, TQ

3100 6680). Other finds in the general vicinity include a Bronze Age socketed axe (MLO 19603) and a Iron Age coin (MLO 9081).

6.0 Methodology

6.1. The archaeological strip was conducted in accordance with the Archaeological Specification compiled by SWAT Archaeology and it also complied with the Institute of Field Archaeologists' Standards and Guidance for Archaeological Watching Briefs (IfA: 1994, revised Oct 2008).

6.2. The works comprised the observation of all ground works, including the inspection of subsoil and natural deposits for archaeological features and finds.

6.3. The archaeological works were carried out in one phase according to the needs of the building contractors from the 23rd-25th June 2014.

6.4. Excavation of the area was carried out by contractors under archaeological supervision using a 360 degree machine equipped with a toothless bucket necessary to remove the topsoil and cut the foundation trenches (Plates 2-4).

6.5. All excavation was carried out under the constant supervision of an experienced archaeologist.

6.6. Where possible the areas of excavation were subsequently hand-cleaned with the intention of revealing any observed features in plan and section.

6.7. If found archaeological features under threat were to be excavated to enable sufficient information about form, development date and stratigraphic relationships to be recorded without prejudice to more extensive investigations, should these prove to be necessary.

6.8. The archaeological works were carried out in accordance with current IfA Standards and Guidance, (IfA: 2008), and methodology provided by the Archaeological Specification issued by SWAT Archaeology.

7.0 Results

7.1 General

No archaeological features or finds were revealed or recovered. The subsoil encountered across the site sand, silty clayey gravel overlaid by demolition and made ground. No archaeological features revealed in the natural geology.

8.0 Finds

No buried archaeological features were located in the Archaeological Monitoring phase and no finds were retrieved.

9.0 Discussion

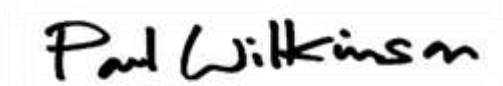
The development site is in an area of archaeological potential. The archaeological team were somewhat disappointed that no archaeology was revealed on the development site.

10.0 Conclusion

The Archaeological Monitoring has fulfilled the primary aims and objectives of the Specification. As far as it is known no buried archaeological features have been affected as a result of the development.

11.0 Acknowledgments

SWAT Archaeology would like to thank Skillcrown Homes Ltd for commissioning the project.

A handwritten signature in black ink that reads "Paul Wilkinson". The signature is written in a cursive style and is enclosed within a thin black rectangular border.

Dr Paul Wilkinson, FRSA., MIfA

References

HER data (KCC 2014)

IFA (1994 & 2008) *Standards and Guidance for Archaeological Watching Briefs*

SWAT Archaeology (2014) *Specification for a Programme of Archaeological Investigation and Assessment of Land at 148 Mitcham Road and Land adjoining 1 Hatton Road Croydon*

Meager (CgMS Consulting Ltd) Desk-based Assessment Report

Greater London HER Team Data

Appendix 1
Greater London HER Summary Form

Site Name: Development site of Land at 148 Mitcham Road and Land adjoining 1 Hatton Road, Croydon CRO 3JE

SWAT Site Code: HATT/SMS/14

Site Address: As above

Summary:

Swale and Thames Survey Company (SWAT) carried out Archaeological Monitoring on the development site above. The site has planning permission for new homes whereby a Archaeological Condition on the Planning Permission required that Archaeological Monitoring be undertaken to determine the possible impact of the development on any archaeological remains.

The Archaeological Monitoring consisted of a constant site presence during groundworks which encountered no buried archaeological features or artefacts.

District/Unitary: London Borough of Croydon

Period(s):

NGR TQ 3142 6672

Type of Archaeological work: Archaeological Monitoring

Date of recording: June 2014

Unit undertaking recording: Swale and Thames Survey Company (SWAT. Archaeology)

Geology: Underlying geology is clay and gravels.

Title and author of accompanying report: Wilkinson P. (2014) Archaeological Monitoring at Land at 148 Mitcham Road and Land adjoining 1 Hatton Road Croydon CRO 3JE

Summary of fieldwork results (begin with earliest period first, add NGRs where appropriate)

See above

Location of archive/finds: SWAT. Archaeology. Graveney Rd, Faversham, Kent. ME13 8UP

Contact at Unit: Paul Wilkinson

Date: 12/08/2014

Plates



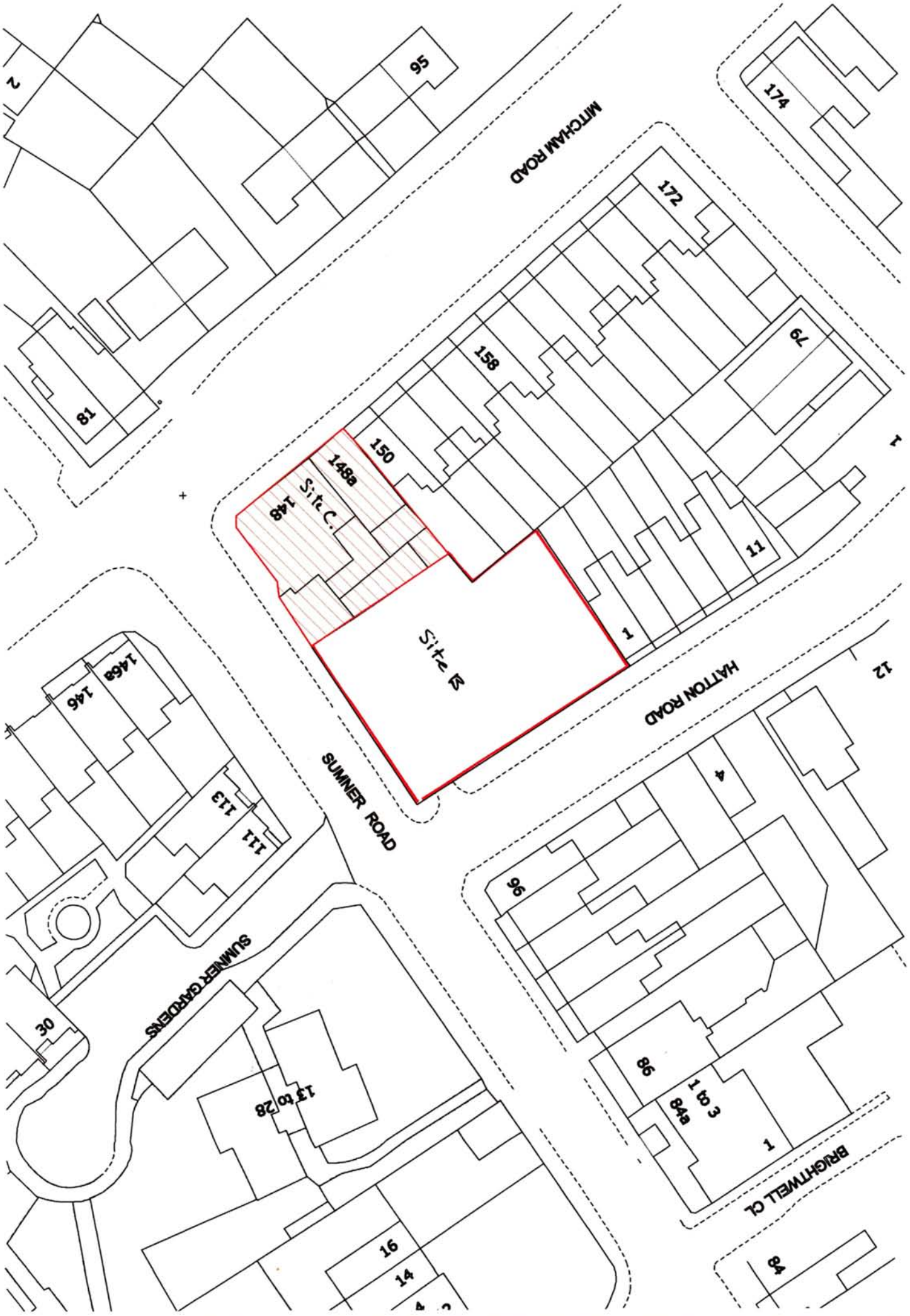
Plate 2. General view of site, facing south

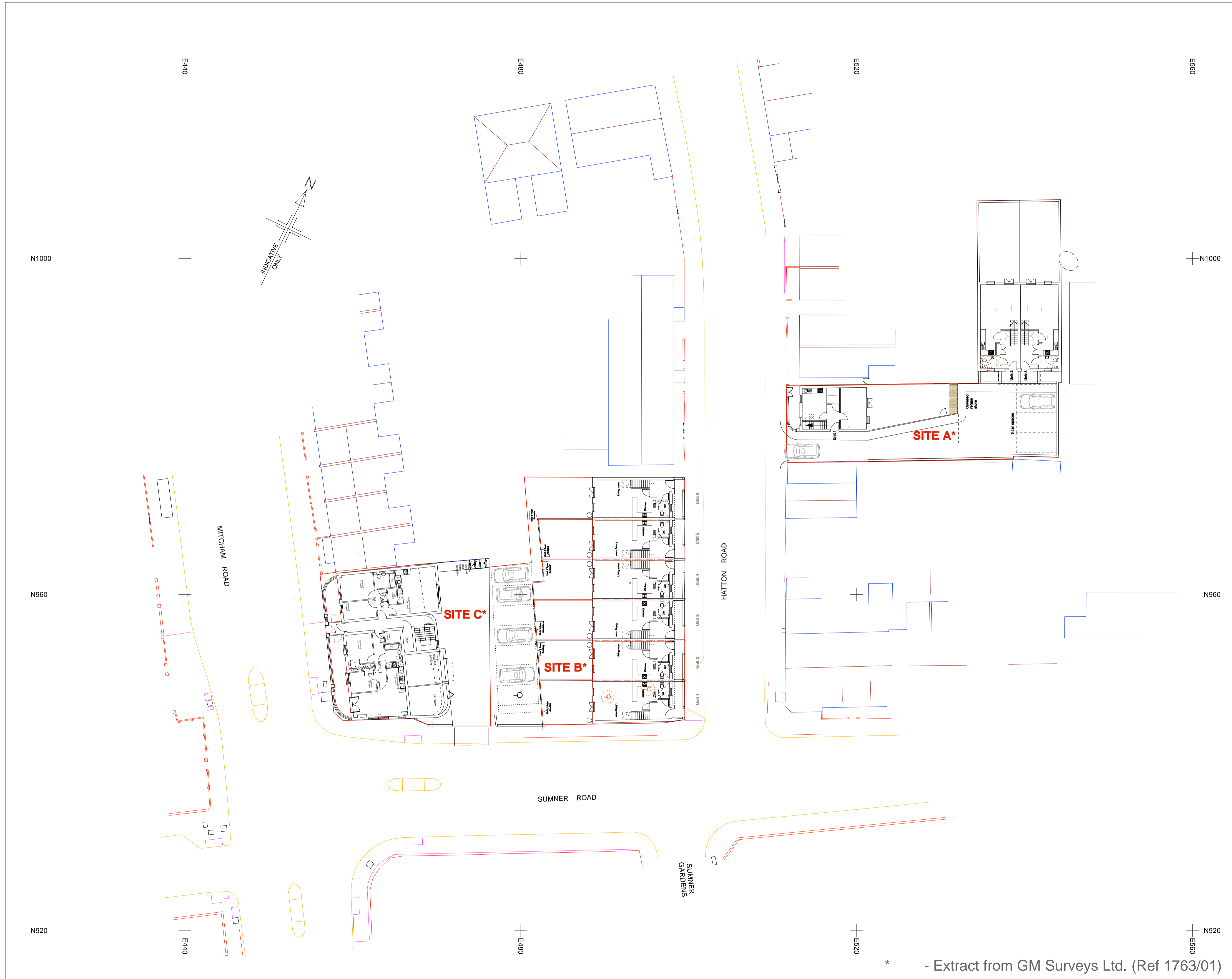


Plate 3. The site showing cutting of foundation trenches (facing north-east)



Plate 4. Foundation trenches (facing north-east)





*please note site boundaries are shown as indicative only subject to confirmation post demolition.